

Lucent TubeLED HO Installation Instructions

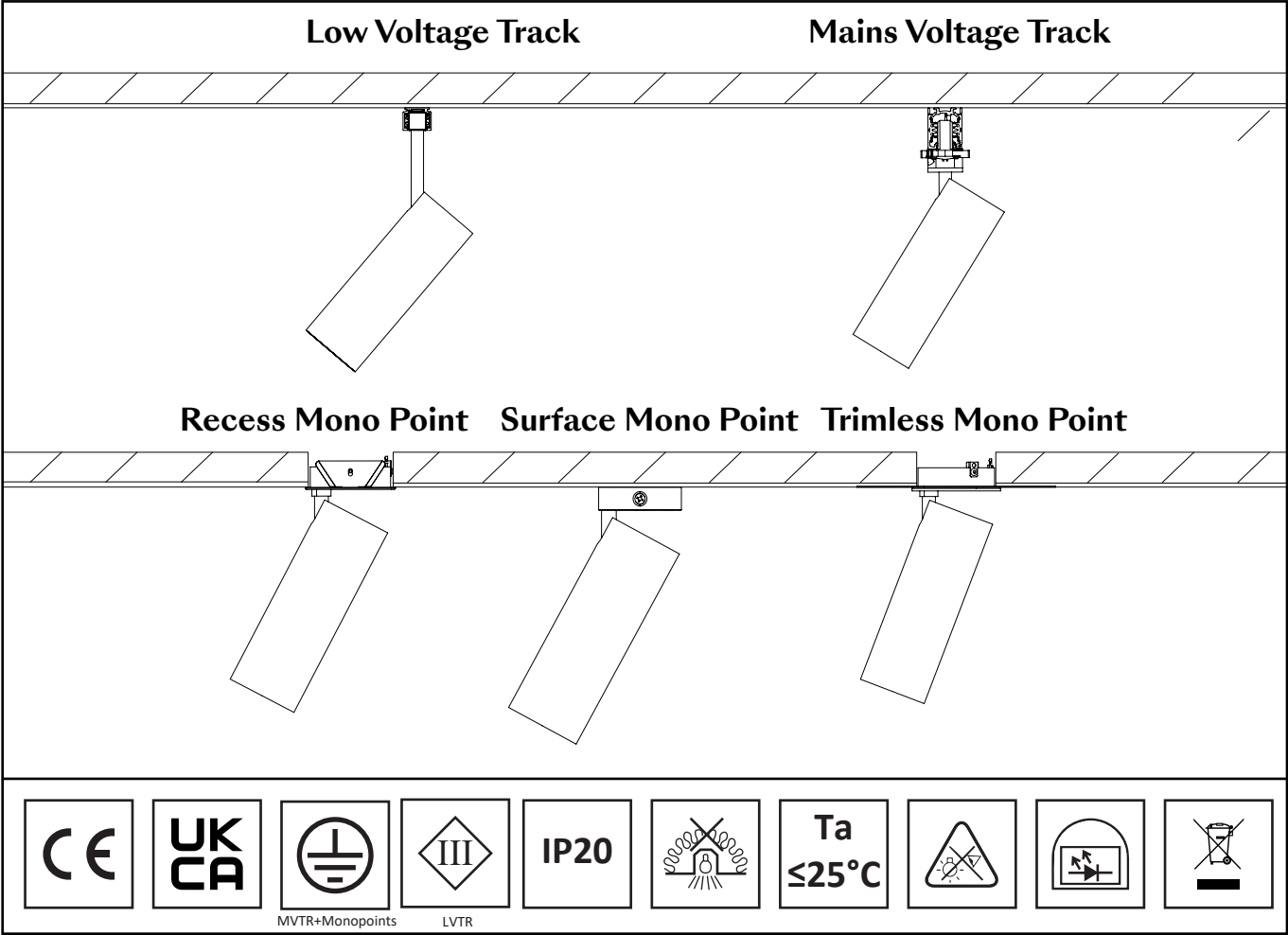

- Please read the following instructions carefully.
- Follow all national and local wiring and safety regulations.
- These products should only be installed by qualified personnel.
- The Low Voltage track systems require a PSU - DO NOT CONNECT DIRECTLY TO MAINS POWER!
- The mono point mounting can be installed with Lucent TubeLED integral driver, which can be plugged to mains power. Or the spotlight can be applied with remote CC driver.
- To prevent damage to the system, only connect products manufactured by Lucent lighting and supplied as part of the TubeLED Mini mounting system
- Optimal ambient temperature ≤ 25°C .
- Operating range of components -20°C - +40°C.
- Do not exceed recommended loading weight and fixing distances.
- Retain these instructions for future reference.
- Control Circuits shall be separated from Low Voltage circuits by at least double insulation

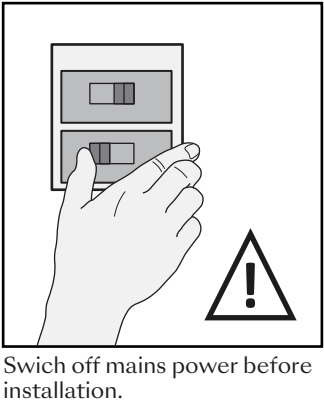

Luminaire Type	Drive Current	Forward Voltage	LED Power
TL603/Q-HE	200mA max.	34VDC	6.8W
TL603/Q-HO	350mA max.	34VDC	11.9W

Servicing LED Spotlight.

- Lucent LED Spotlight’s light source is non user replaceable.
- LED Spotlights should only be replaced a qualified person, the manufacturer or a similar qualified person.

TubeLED HO Low Voltage Track application

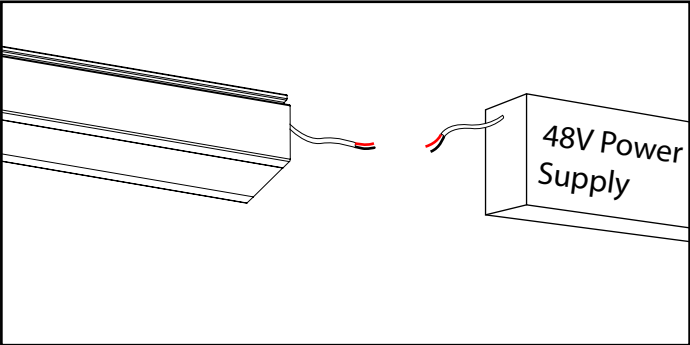

1. After the installation of the low voltage track, connect with a 48V constant voltage power supply. Check the overall power required for the correct 48V power supply.

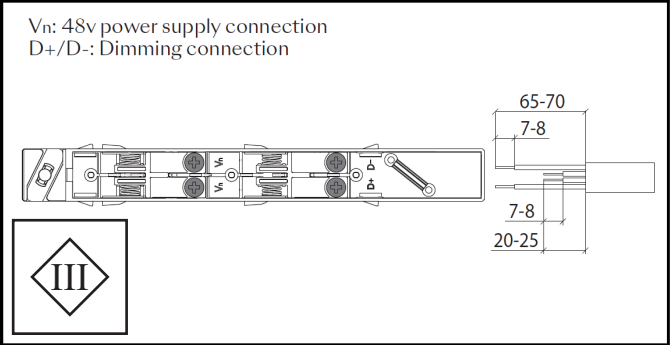

2. Strip cable as shown and connect to electrical contacts

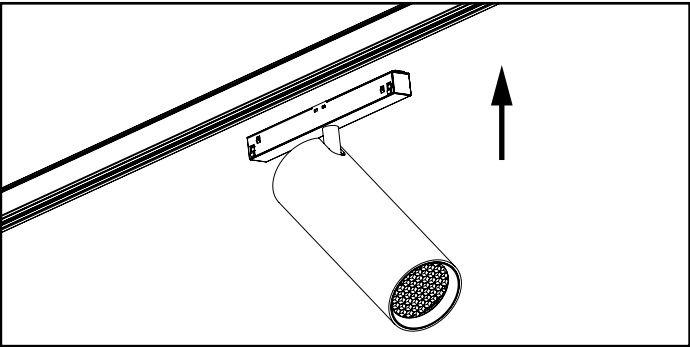

3. Insert the track adaptor into the track slot.

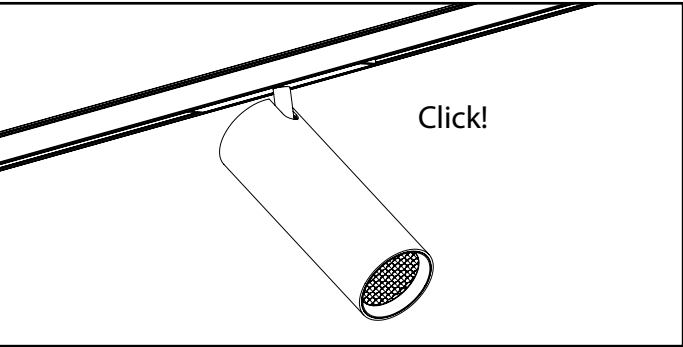

4. Clip the spotlight into the track adaptor and check whether it is fitted tightly

TubeLED HO Mains Voltage Track application

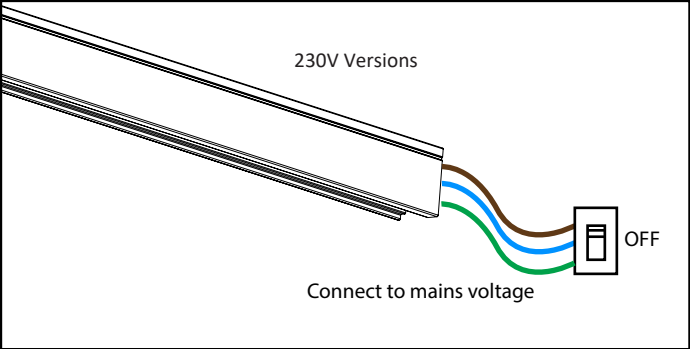

1. After the installation of the mains voltage track, connect to the mains voltage. Before install the spotlights, do not turn on the mains power otherwise it

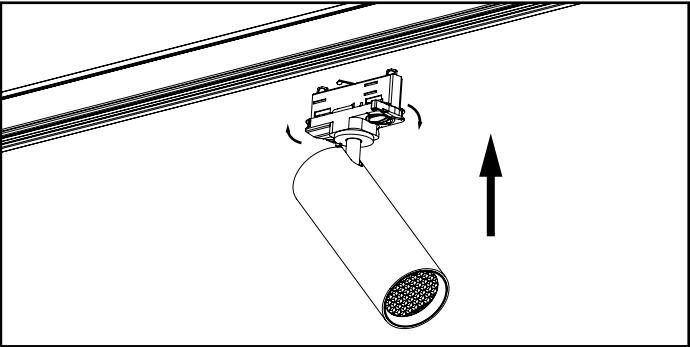
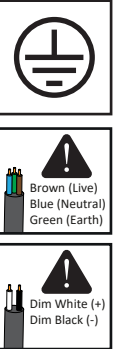

2. Twist to pull the conductive latch in and insert the track adaptor into the track slot.

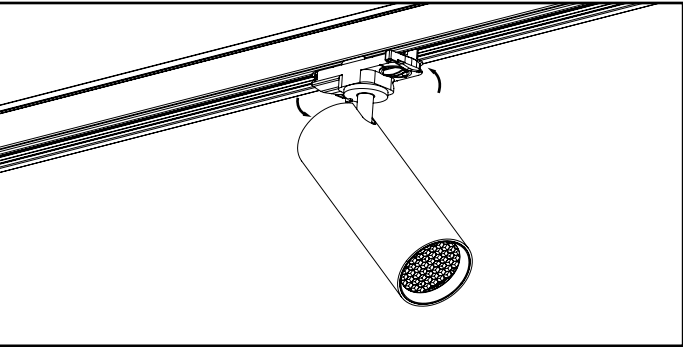

3. Once it is fitted tightly, twist the conductive latch anti-clock way to catch the track and fix the entire spotlight. But do not turn on the mains power until all of the spotlights light in the track have been installed completely.

TubeLED HO Surface Mono Point installation

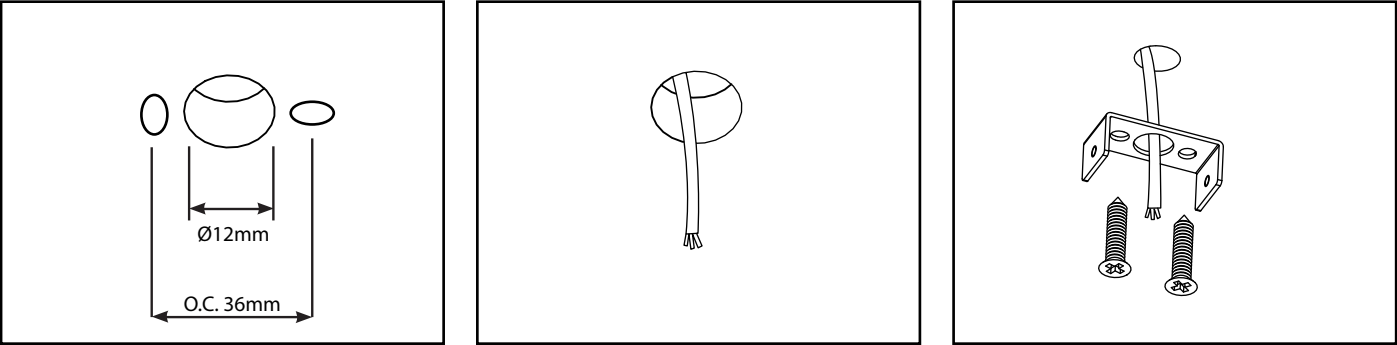

1. Cut the cable to the correct length. Connect the cable to the low voltage track, connected to a 48V boost light. Voltage of the supply is 36V. Check the overall power required for the correct 48V power supply.
3. Feed cables through the bracket and secure the cable to the ceiling. Screw the bracket onto the ceiling tightly.

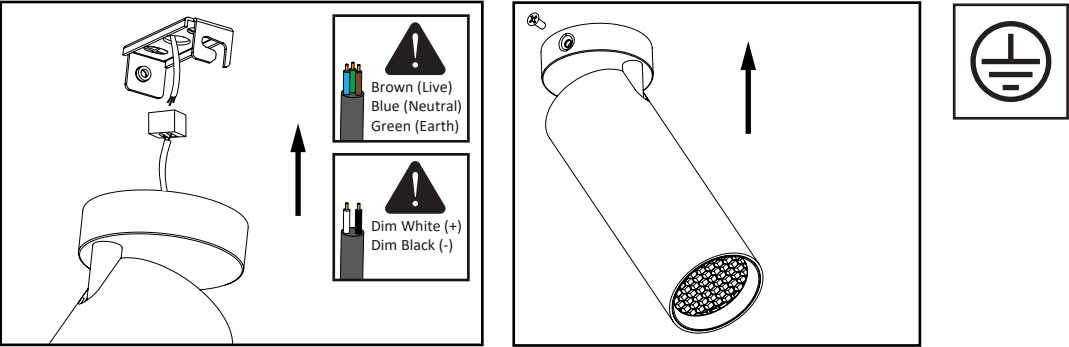

4. Make the electrical connection
5. Place the ceiling canopy over the bracket and then secure with a screw provided.

TubeLED HO Recessed Mono Point Installation

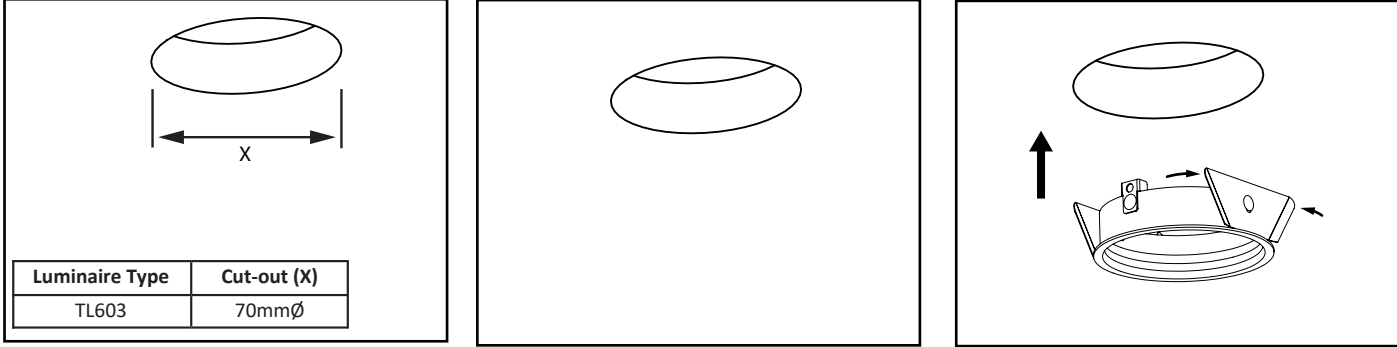

1. Cut-out to allow the installation of the luminaire
3. Push the springs inward and insert the Trim Kit

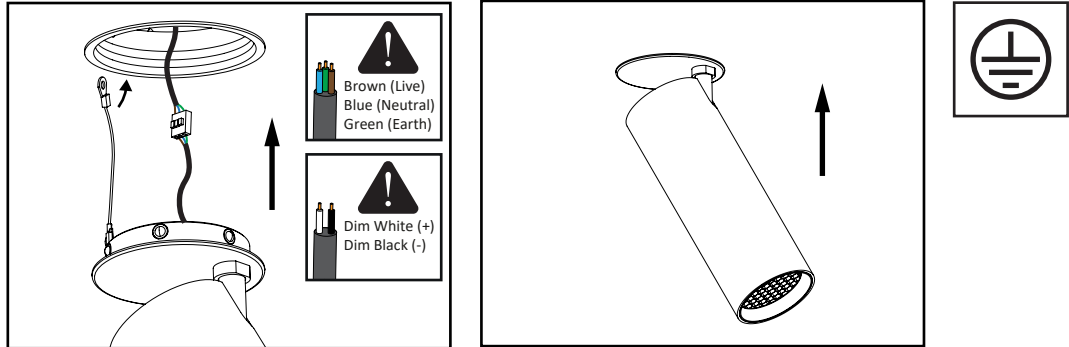

4. Clip and connect the security cable and make the electrical connection.
5. Clip and push spotlight top plate into the Trim Kit.

TubeLED HO Trimless Recessed Mono Point Installation

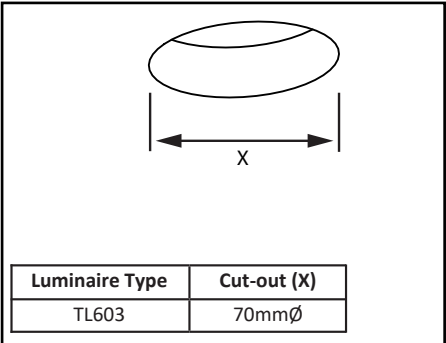

1. Cut-out to allow the installation of the luminaire

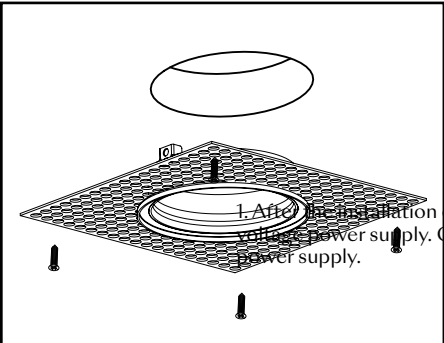

2. Insert the Trimless Kit into the ceiling hole and then screw to fix the Trimless Mesh on the ceiling

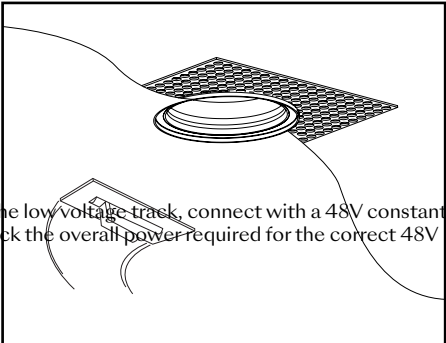

3. Plaster to cover the mesh and allow to dry

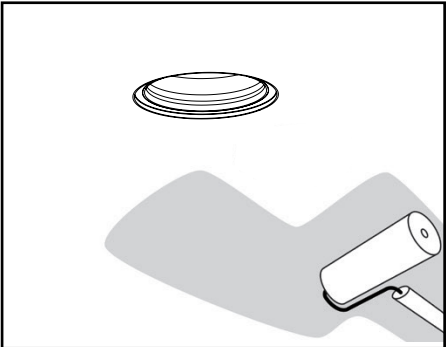

4. Paint and allow to dry fully

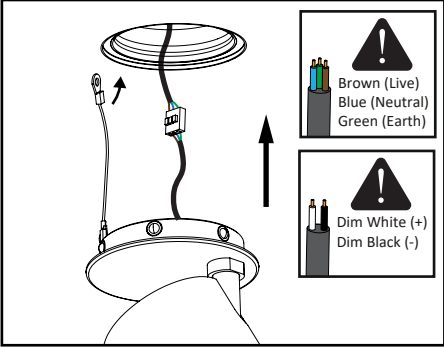

5. Clip and connect the security cable and make the electrical connection.

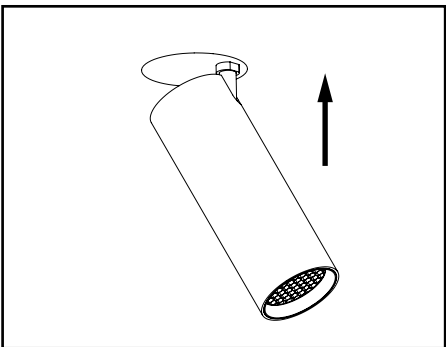

6. Clip and push spotlight top plate into the Trim Kit.